

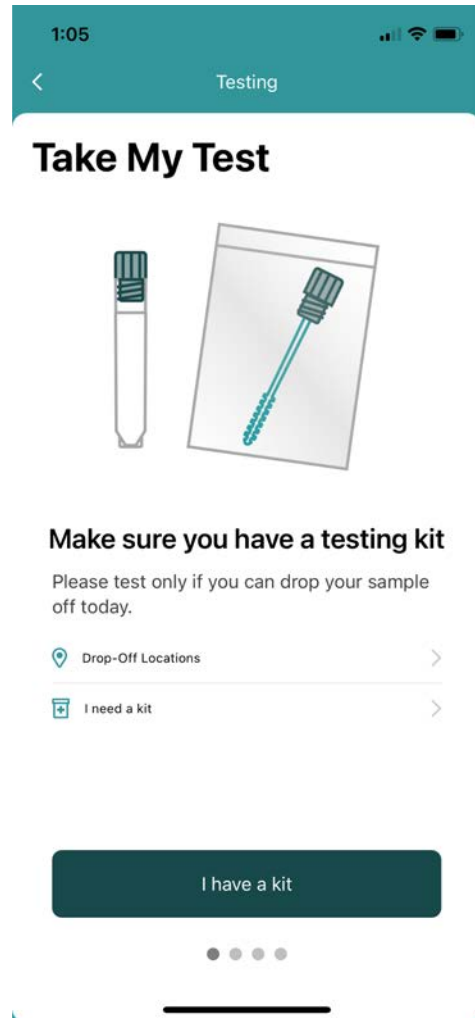

This is your kit.

Remove everything from the bag:
a packaged swab,
a tube for your swab, and
an insert with your barcode.

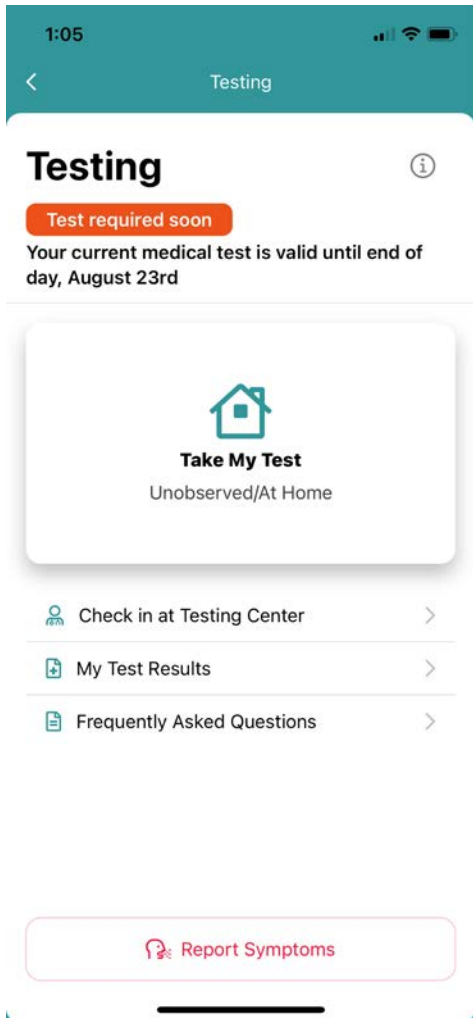



Open the Atlas app
Tap “Medical”
Tap “Take My Test”
Tap “I have a kit”

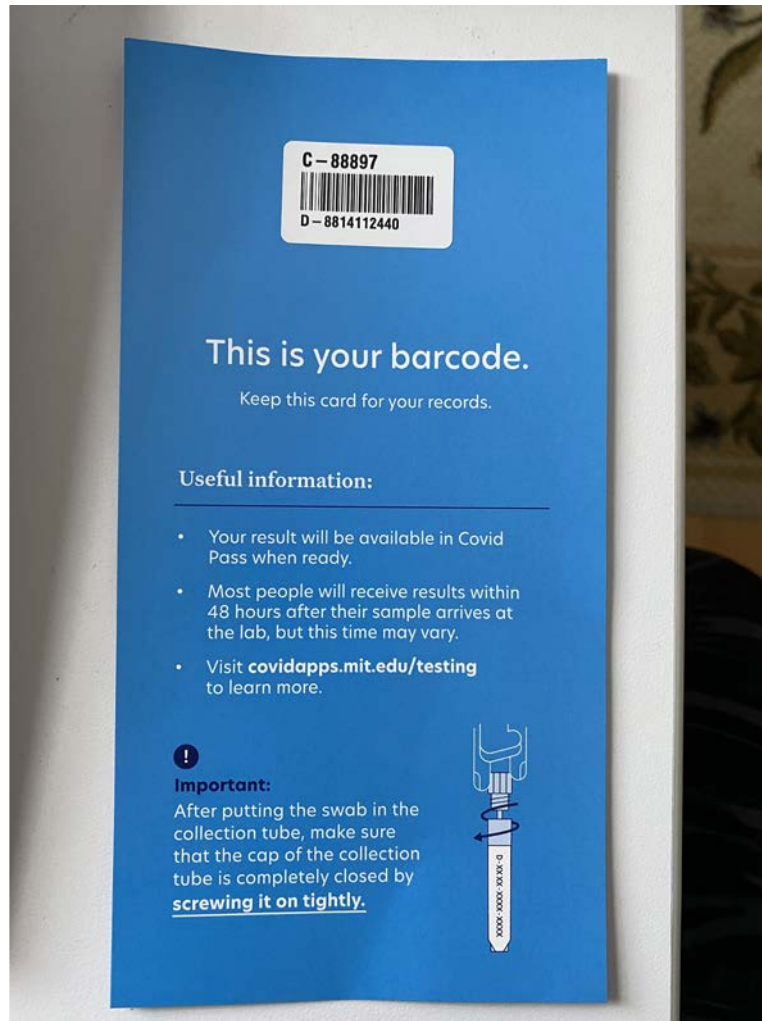

Use the camera on your mobile device to scan the barcode on the tube or the insert.

Take My Test



Swab

Please follow the detailed instructions to swab along the insides of each nostril for 15 seconds.

 Detailed Instructions >

D-9606488279 

I have finished swabbing



Take My Test



Almost Done

Make sure the swab is screwed on tightly. Please remove everything from the plastic bag. Place your test tube in the plastic bag, seal it and take it to a drop-off location today.

 Drop-Off Locations >

D-9606488279

Complete My Test



Swab as directed in the detailed instructions. Be sure to tap “Complete My Test” before closing the app.

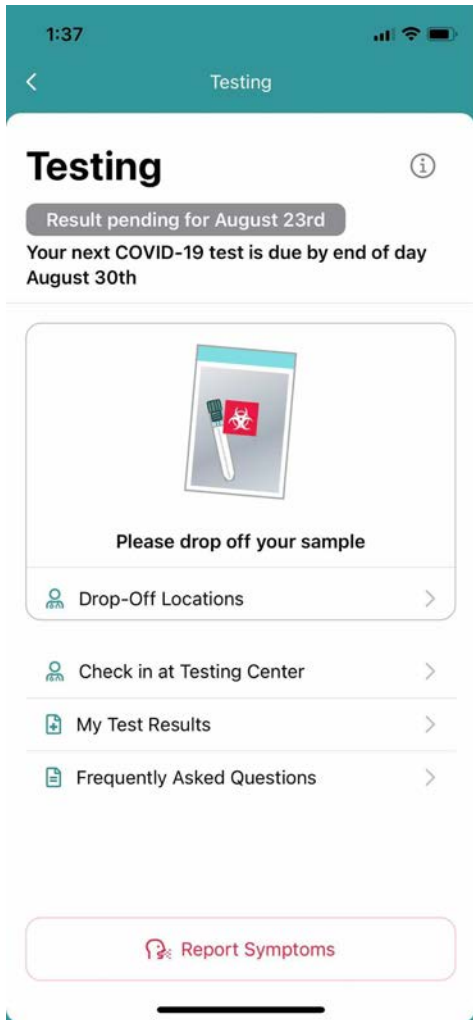

To confirm your test has been checked in, you may view your test status in the app. If you see “Result pending” and “Please drop off your sample,” your scan was successful. If you do not see this screen, you may need to scan again.

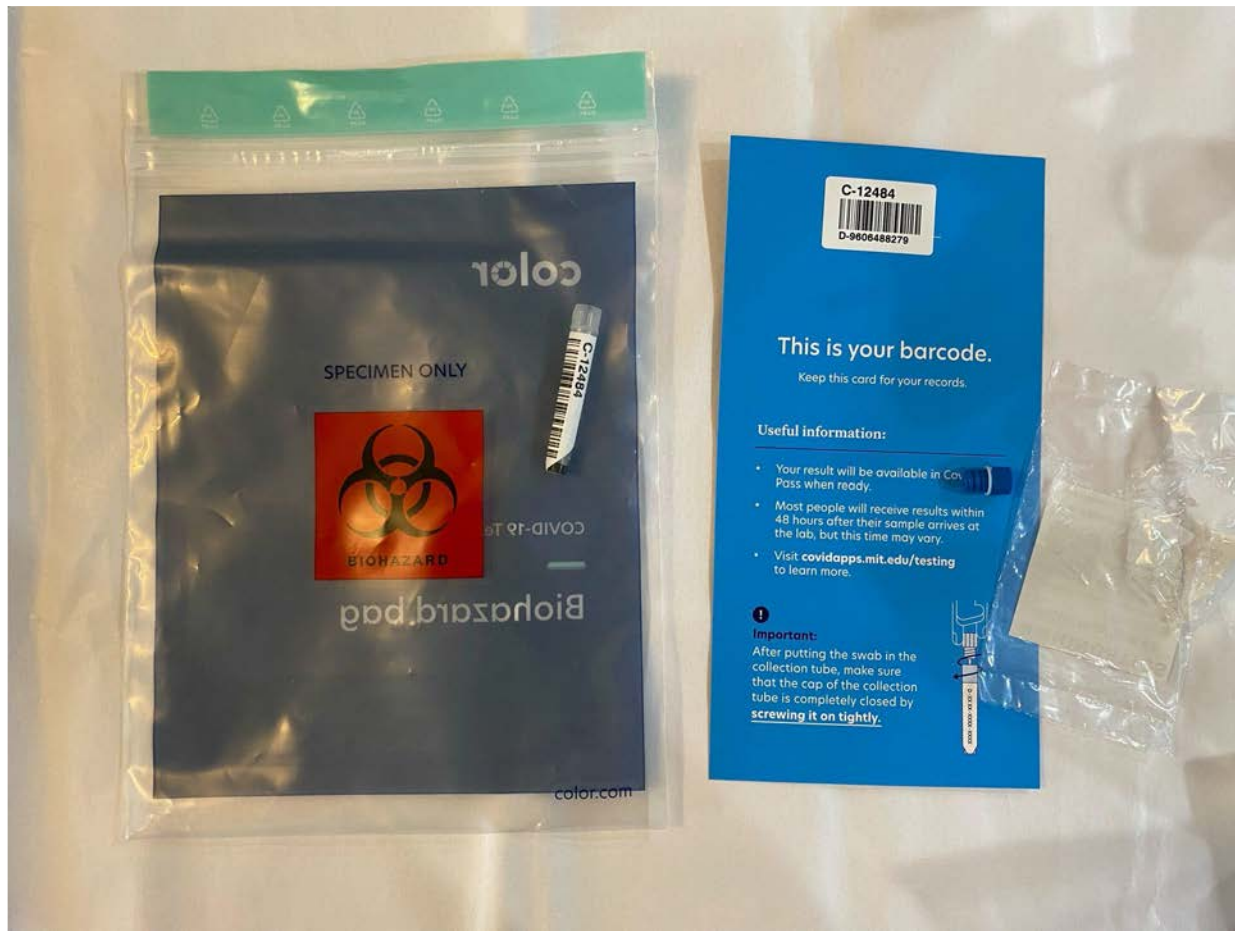

Remember:
Only drop off the sealed bag with your swab in the tube.
Keep the card until your result is returned, then recycle it.